

YT 75 TON SLIP TYPE ELEVATOR

| | DESCRIPTION | SIZE OF LINKS | WT. |
|-------|--------------------------------------|-----------------|--------|
| 23105 | YT ELEVATOR COMPLETE LESS SLIP ASSY. | 2 1/4" - 2 3/4" | 355.00 |

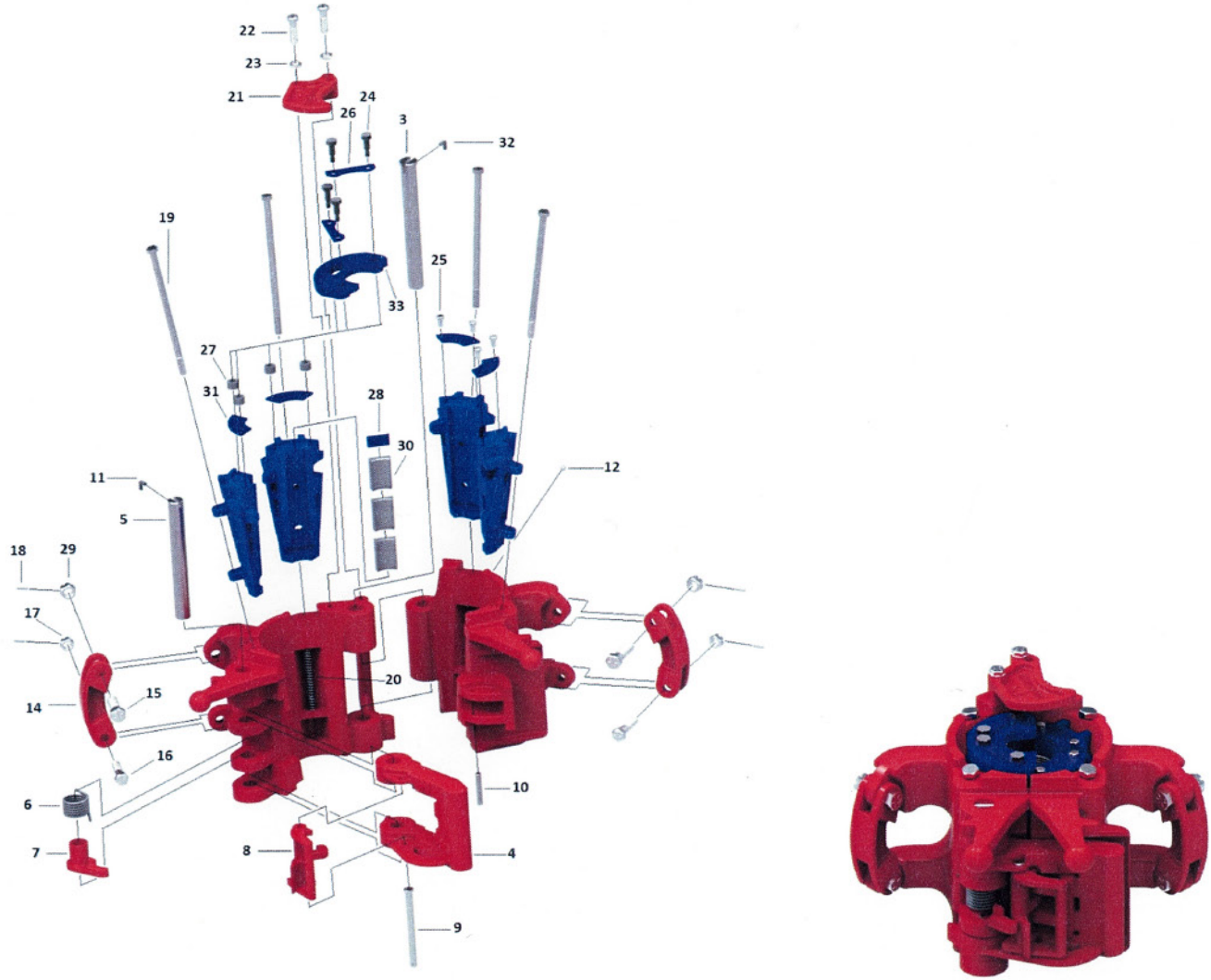

YT SLIP ASSEMBLIES

| | DESCRIPTION | WT. |
|----------|---|-------|
| 23108-5 | 3 1/2" x 3 1/2" YT SLIP ASSEMBLY | 64.00 |
| 23108-3 | 3 1/2" x 2 7/8" YT SLIP ASSEMBLY | 76.00 |
| 23108-4 | 2 7/8" x 2 7/8" YT SLIP ASSEMBLY | 76.00 |
| 23108-6 | 2 7/8" x 2 3/8" YT SLIP ASSEMBLY | 79.00 |
| 23108-7 | 2 7/8" x 2 1/16" YT SLIP ASSEMBLY | 81.00 |
| 23108-8 | 2 7/8" x 2" (2.000") YT SLIP ASSEMBLY | 82.00 |
| 23108-9 | 2 7/8" x 1 1/2" (1.900") YT SLIP ASSEMBLY | 83.50 |
| 23108-10 | 2 7/8" x 1 1/4" (1.660") YT SLIP ASSEMBLY | 85.50 |
| 23108-11 | 2 7/8" x 1" (1.315") YT SLIP ASSEMBLY | 86.50 |
| 23108 | 3 1/2" YT SLIP SEGMENTS ONLY (MATCHED SET OF 4) | 51.00 |
| 23108-2 | 2 7/8" YT SLIP SEGMENTS ONLY (MATCHED SET OF 4) | 51.00 |

YT 75 TON SLIP TYPE ELEVATOR

YT REPLACEMENT PARTS

| ITEM# | DESCRIPTION | **SPARES | #REQ. | WT. |
|-----------|--------------------------------|----------|-------|-------|
| 23116-1 | HINGE PIN | | 1 | 4.13 |
| 15348 | LATCH | | 1 | 27.00 |
| 24182 | LATCH PIN | | 1 | 5.00 |
| 12978 | LATCH SPRING | 2 | 1 | .63 |
| 12946 | LATCH CAM | | 1 | 1.50 |
| 12972 | LATCH LOCK | | 1 | 3.50 |
| 13530 | LATCH LOCK PIN | 2 | 1 | .63 |
| 12529 | DOOR LUG PIN | | 1 | .65 |
| 29464 | LATCH PIN RETAINER | 2 | 1 | .20 |
| 940308-1 | GREASE FITTING | | 1 | .10 |
| 940308-8 | GREASE FITTING | | 1 | .10 |
| 9519 | LINK BLOCK | | 2 | 5.50 |
| 8145-1 | UPPER LINK BLOCK BOLT ASSEMBLY | | 2 | .50 |
| 8145-2 | LOWER LINK BLOCK BOLT ASSEMBLY | 2 | 2 | 1.19 |
| 8150 | LOWER LINK BLOCK NUT | 2 | 2 | .25 |
| 939672-19 | COTTER PIN | 2 | 2 | .10 |
| 23115 | SLIP BOLT | 4 | 4 | 1.25 |
| 23115-1 | SLIP BOLT | 4 | 4 | 1.25 |
| 23113 | SLIP SPRING | 8 | 4 | .25 |
| 23630 | GUIDE PLATE | | 1 | 4.00 |
| 939098-75 | GUIDE PLATE SCREW | 2 | 2 | .25 |
| 939352-64 | GUIDE PLATE LOCKWASHER | 2 | 2 | .15 |
| 27697 | SETTING PLATE BOLT | 8 | 4 | .25 |
| 27532 | INSERT RETAINER SCREW | 8 | 4 | .06 |
| 27546 | SETTING RING RETAINER (3 1/2") | 2 | 2 | .13 |
| 27507 | SETTING RING RETAINER (2 7/8") | 2 | 2 | .13 |
| 27696 | RUBBER BUSHING | 8 | 4 | .06 |
| 24507 | INSERT SPACER (3 1/2") | 8 | 8 | .13 |
| 24508 | INSERT SPACER (2 7/8") | 4 | 4 | .25 |
| 27530 | INSERT RETAINER (3 1/2") | | 4 | .13 |
| 27451 | INSERT RETAINER (2 7/8") | | 4 | .25 |
| 23117 | HINGE PIN RETAINER | 2 | 1 | .25 |

YT INSERTS

| ITEM# | DESCRIPTION | #REQ. | WT. |
|-------|---------------------------------|-------|------|
| 24774 | 3 1/2" X 3 1/2" INSERT | 24 | .50 |
| 30358 | 3 1/2" X 2 7/8" INSERT | 24 | .75 |
| 78-06 | 3 1/2" X 2 3/8" INSERT | 24 | .80 |
| 24773 | 2 7/8" X 2 7/8" INSERT | 12 | .75 |
| 29255 | 2 7/8" X 2 3/8" INSERT | 12 | 1.00 |
| 29256 | 2 7/8" X 2 1/16" & 2" INSERT | 12 | 1.20 |
| 29257 | 2 7/8" X 1 1/2" (1.900") INSERT | 12 | 1.25 |
| 29258 | 2 7/8" X 1 1/4" (1.660") INSERT | 12 | 1.38 |
| 29259 | 2 7/8" X 1" (1.315") INSERT | 12 | 1.45 |

RECOMMENDED SPARES INCLUDE 1 SET OF INSERTS FOR EACH PIPE SIZE TO RUN

YT 75 TON SLIP TYPE ELEVATOR

YT SETTING RINGS

| | ITEM# | DESCRIPTION | WT. |
|-------|-------|---------------------------------|------|
| 27813 | 33 | 3 1/2" YT SETTING RING | 3.13 |
| 27695 | 33 | 2 7/8" YT SETTING RING | 3.56 |
| 27694 | 33 | 2 3/8" YT SETTING RING | 4.00 |
| 27812 | 33 | 2 1/16" YT SETTING RING | 4.25 |
| 27811 | 33 | 1 1/2" (1.900") YT SETTING RING | 4.31 |
| 27810 | 33 | 1 1/4" (1.660") YT SETTING RING | 4.38 |
| 29001 | 33 | 1" (1.315") YT SETTING RING | 4.75 |

RECOMMENDED SPARES INCLUDE 2 SETTING RINGS FOR EACH PIPE SIZE TO BE RUN