

TYPE "MP" SAFETY CLAMPS

Type "MP" Safety Clamp is ideal to help safeguard against dropping strings of flush joint tubing while making up or breaking out the string. The multi-link design provides uniform pressure around the pipe reducing the risk of crushing or damaging the pipe. Each assembly is provided with its own aluminum box as a standard option.

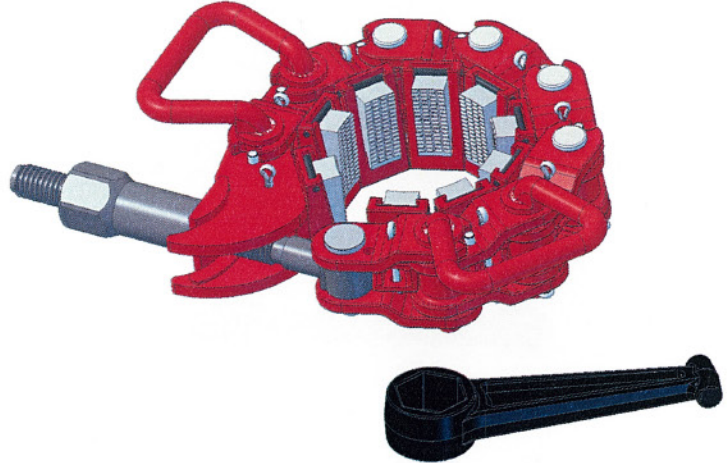

TYPE "MP" SAFETY CLAMP ASSEMBLIES COMPLETE

	RANGE	REF#	# LINKS	GRIPPING DIES	WT.
MP-S					
31-009	2 7/8" - 4 1/8"	33030	7	8	128.00
31-010	4" - 5"	33031	8	9	133.00
MP-R					
31-011	4 1/2" - 5 5/8"	33011	7	8	120.00
31-012	5 1/2" - 7"	33012	8	9	130.00
31-013	6 3/4" - 8 1/4"	33013	9	10	138.00
31-014	8" - 9 1/4"	33014	10	11	147.00
31-015	9 1/4" - 10 1/2"	33015	11	12	155.00
MP-M					
31-016	10 1/2" - 11 1/2"	33016	12	13	163.00
31-017	11 1/2" - 12 1/2"	33017	13	14	171.00
31-018	12 1/2" - 13 5/8"	33018	14	15	179.00
31-019	13 5/8" - 14 3/4"	33019	15	16	187.00
31-020	14 3/4" - 15 7/8"	31020	16	17	195.00
MP-L					
31-021	15 7/8" - 17"	33021	17	18	215.00
31-022	17" - 18 1/2"	33022	18	19	223.00
31-023	18 1/8" - 19 3/8"	33023	19	20	231.00
MP-XL					
31-024	19 3/8" - 20 3/8"	33024	19	20	280.00
31-025	20 3/8" - 21 1/2"	33025	20	21	288.00
31-032	21" - 22 5/8"	33032	21	22	296.00
31-033	22 5/8" - 23 3/4"	33033	22	23	304.00
31-034	23 3/4" - 24 7/8"	33034	23	24	312.00
31-035	24 7/8" - 26"	33035	24	25	320.00
31-036	26" - 27 1/8"	33036	25	26	328.00
31-039	29 3/8" - 30 1/2"	33039	28	29	336.00

TYPE "MP" SAFETY CLAMPS

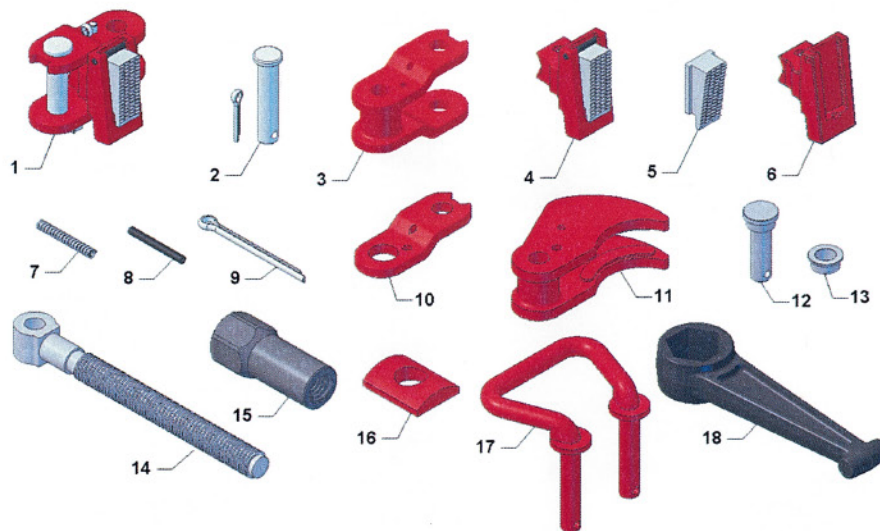

REPLACEMENT PARTS FOR "MP" TYPE SAFETY CLAMPS

PART#	ITEM#	DESCRIPTION	CLAMP TYPE	REF.#	QTY.	WT.
31-335	1	LINK COMPLETE	MP-S ONLY	3335	AR	9.00
31-319	1	LINK COMPLETE	ALL EXCEPT MP-S	3319	AR	8.75
31-307	2	PIN, FOR LINK (w/COTTER)	ALL	3307	AR	.75
31-306	3	LINK (W/COTTER)	ALL	3306	AR	4.50
31-325	4	CARRIER ASSY. (w/DIE)	MP-S ONLY	3325	AR	3.00
31-324	4	CARRIER ASSY. (w/DIE)	ALL EXCEPT MP-S	3324	AR	2.50
31-333	5	DIE (w/COTTER)	MP-S ONLY	3333	AR	1.50
31-310	5	DIE (w/COTTER)	ALL EXCEPT MP-S	3310	AR	1.00
31-309	6	CARRIER (LESS DIE)	ALL	3309	AR	2.50
31-311	7	SPRING	ALL	3311	AR	.10
31-418	8	ROLL PIN (DIE KEEPER)	ALL	51604-18	AR	.10
31-528	9	COTTER PIN (f/CARRIER)	ALL	51405-28	AR	.18
31-318	10	SIDE BAR LINKS (PAIR)	ALL	3318	AR	2.50
31-304	11	LATCH LINK	ALL EXCEPT MP-XL	3304	1	7.00
31-321	11	LATCH LINK	MP-XL ONLY	3321	1	14.00
31-308	12	PIN FOR SCREW, (w/COTTER)	ALL	3308	1	.50
31-315	13	BUSHING F/SCREW PIN	ALL	3315	1	.33
31-510		COTTER F/LINK PIN	ALL	51405-10	AR	.08
31-302	14	SCREW	ALL	3302	1	5.25
31-303	15	NUT F/ SCREW	ALL	2714	1	1.00
31-714	16	THRUST WASHER	ALL	3303	1	3.50
31-305	17	HANDLE	MP-S,MP-R, & MP-M	3305	2	4.50
31-305	17	HANDLE	MP-L & MP-XL	3305	4	4.50
31-316	N/P	HOLD DOWN LUG	ALL	3316	OPT.	5.75
31-317	N/P	LIFTING EYE	ALL	3317	OPT.	4.75
31-320	18	NUT WRENCH	ALL	3320	1	5.00

RECOMMENDED SPARE PARTS FOR 1 YEAR FOR "MP" TYPE CLAMPS

PART#	DESCRIPTION	MP -S	MP -R	MP -M	MP -L	MP -XL
31-333	DIE W/COTTER	4				
31-310	DIE W/COTTER		6	8	10	13
31-311	SPRING	9	12	17	20	26
31-528	PIN W/COTTER	4	6	8	10	13
31-418	ROLL PIN	9	12	17	20	26