

TYPE "C" SAFETY CLAMP

Type "C" Safety Clamp is one of the most valuable tools on the Rig Floor. It helps guard against dropping flush-joint pipe, streamlined drill collars, etc. into the hole while making-up or breaking-out the string. Literally, it has dozens of money and time-saving applications in oilfield work, in addition to giving increased protection against fishing jobs.

The Safety Clamp consists of individual links, flexibly hinged together. Each link has a separate tapered slip which acts as a gripping member, much like a tapered rotary slip, and each slip is held in a retracted position on the taper by spring tension. When the clamp is tightened, each small slip takes a firm initial grip on the surface of the pipe. Should the pipe start to fall, or should load increase occur against the slips, the taper mounting causes each slip to wedge tighter against the surface of the pipe to increase the grip or lock the pipe against further movement.

Gripping pressure is always uniform around the pipe so there is little danger of crushing thin-walled pipe or damaging the pipe surface and, since each link, complete with tapered slip, is interchangeable as a unit; the Safety Clamp is readily adaptable to virtually any diameter. Each link changes the effective gripping diameter of the clamp one inch. All parts are made of alloy steel, heat-treated for strength and gripping ability.

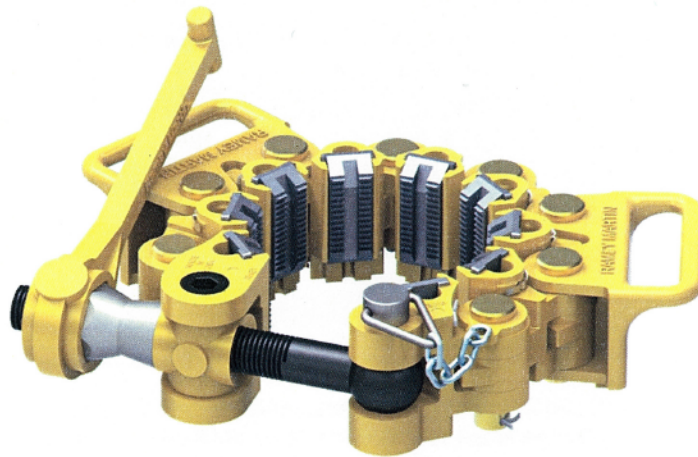

CLAMPS WITH HANDLES & WRENCH

TYPE "CR" (SINGLE SCREW)

	RANGE O.D. SIZE	LINKS REQUIRED	WT.
12-127	3 3/4" - 4 5/8"	7	45.00
12-128	4 1/2" - 5 5/8"	8	54.00
12-129	5 1/2" - 6 5/8"	9	60.00
12-130	6 1/2" - 7 5/8"	10	63.00
12-131	7 1/2" - 8 5/8"	11	68.00
12-132	8 1/2" - 9 5/8"	12	72.00
12-133	9 1/2" - 10 5/8"	13	87.00

TYPE "C" SAFETY CLAMP

TYPE "CL" (SINGLE SCREW)

PART #	RANGE O.D. SIZE	LINKS REQUIRED	WT.
12-134	10 1/2" - 11 5/8"	14	72.00
12-135	11 1/2" - 12 5/8"	15	77.00
12-136	12 1/2" - 13 5/8"	16	82.00
12-137	13 1/2" - 14 5/8"	17	87.00
12-138	14 1/2" - 15 5/8"	18	92.00

TYPE "C X L" (DOUBLE SCREW)

PART #	RANGE O.D. SIZE	LINKS REQUIRED	WT.
12-145	15 1/2" - 17"	18	114.00
12-146	16 1/2" - 18"	19	119.00
12-147	17 1/2" - 19"	20	124.00
12-148	18 1/2" - 20"	21	129.00

CLAMPS WITH LIFTING CLEVIS

TYPE "CL" (SINGLE SCREW) CLAMPS WITH LIFTING CLEVIS

PART #	RANGE O.D. SIZE	LINKS REQUIRED	WT.
12-150	10 1/2" - 11 5/8"	14	83.00
12-151	11 1/2" - 12 5/8"	15	88.00
12-152	12 1/2" - 13 5/8"	16	93.00
12-153	13 1/2" - 14 5/8"	17	98.00
12-154	14 1/2" - 15 5/8"	18	102.00

TYPE "C X L" (DOUBLE SCREW) CLAMPS WITH LIFTING CLEVIS

PART #	RANGE O.D. SIZE	LINKS REQUIRED	WT.
12-155	15 1/2" - 17"	18	112.00
12-156	16 1/2" - 18"	19	117.00
12-157	17 1/2" - 19"	20	122.00
12-158	18 1/2" - 20"	21	127.00
12-159	19 1/2" - 21"	22	132.00
12-160	21 1/8" - 23"	24	.00
12-161	24 1/8" - 26"	27	.00
12-162	29 1/2" - 31"	32	182.00
12-163	35 1/2" - 37"	38	212.00
12-164	41 1/2" - 47"	44	242.00

ADD -"B" TO END OF PART # TO INCLUDE BOX
ALL CLAMPS COME COMPLETE WITH WRENCH

TYPE "C" SAFETY CLAMP

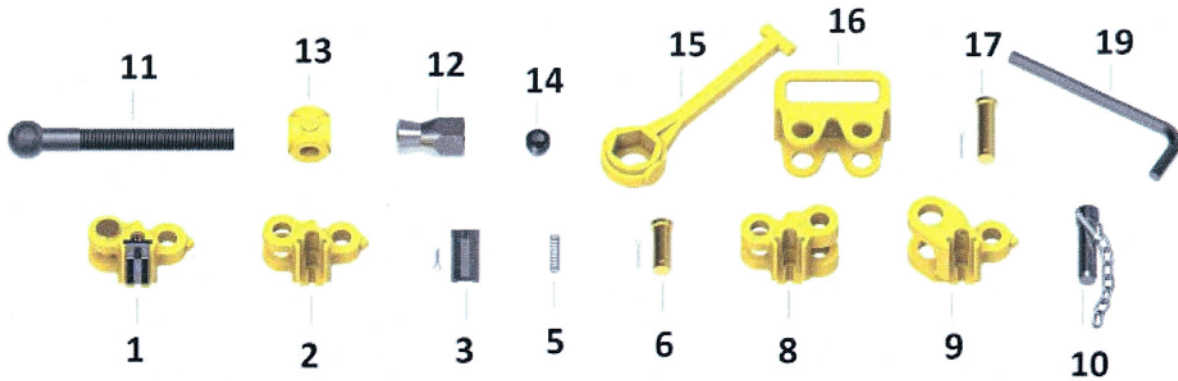

REPLACEMENT PARTS FOR TYPE "C" SAFETY CLAMP

	ITEM	DESCRIPTION	**SPARES	WT.
12-101	1	LINK ASSY. COMPLETE		5.00
12-102	2	LINK INTERMEDIATE	6	3.75
12-103	3	INSERT w/COTTER	1 SET	.50
12-104		COTTER f/INSERT		.06
12-105	5	SPRING f/INSERT	1 SET	.06
11-106	6	LINK PIN w/COTTER	6	.75
11-107		COTTER f/LINK PIN		.06
12-108	8	END LINK (SCREW)		4.50
12-109	9	END LINK (PIVOT BLOCK)		3.50
11-110	10	END LINK PIN w/CHAIN	1	1.25
11-111	11	SCREW		4.00
11-112	12	NUT		1.50
11-113	13	PIVOT BLOCK		1.50
11-114	14	PIVOT BLOCK PIN		.25
11-115	15	NUT WRENCH		3.50
12-116	16	HANDLE (CAST STEEL)		3.00
11-117	17	HANDLE LINK PIN w/COTTER		.75
12-118	N/P	HANDLE KIT		4.00
11-119	19	PIVOT BLOCK PIN WRENCH		.25
11-120	N/P	SAFETY CLAMP BOX		20.00
12-119	21/22	LIFTING CLEVIS COMPLETE		15.00
12-120	21	LIFTING CLEVIS ONLY		9.00
12-121	22	BOLTS W/NUTS AND COTTERS		2.50

ALL PARTS ARE INTERCHANGEABLE WITH CORRESPONDING DESIGN TYPE "C" SAFETY CLAMPS
**** RECOMMENDED SPARE PARTS FOR 1 YEARS SERVICE**