

## MGG (250 TON) BOTTLENECK ELEVATOR

	RANGE	SIZE OF LINKS	WT.
35005	3 1/2" - 5 1/2"	2 1/4" - 3 1/2"	600.00

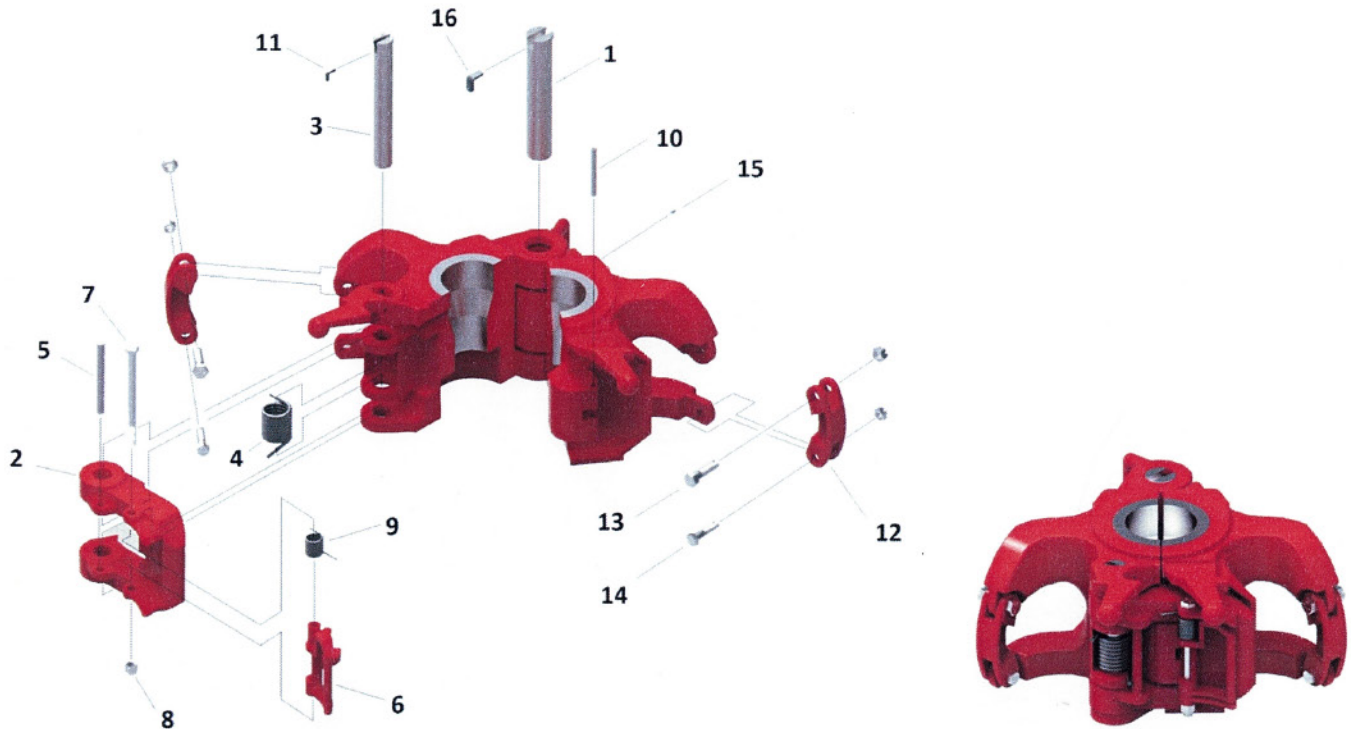

### REPLACEMENT PARTS FOR MGG ELEVATORS

	ITEM#	DESCRIPTION	SPARES	#REQ.	WT.
	34908	1 HINGE PIN	*	1	15.50
	34906	2 LATCH		1	57.00
	34907	3 LATCH PIN	*	1	7.31
	34909	4 LATCH SPRING	2	1	2.50
	13185	5 LATCH SPRING STOP	1	1	.94
	13152	6 LATCH LOCK	*	1	4.00
	15101	7 LATCH LOCK BOLT	2	1	1.30
	939484-8	8 LATCH LOCK BOLT NUT	2	1	.20
	13188	9 LATCH LOCK SPRING	2	1	.30
	13190	10 DOOR LUG PIN		1	.32
	34911	11 LATCH PIN RETAINER	2	1	.13
	12732	N/P DOOR CATCH ARM		1	1.50
	12916	N/P DOOR CATCH ARM PIN		1	.13
	9561	N/P DOOR CATCH SPRING	*	1	.13
	12734	N/P ROLLER		1	.50
	12735	N/P ROLLER PIN		1	.25
	9519	12 LINK BLOCK		2	5.50
	8145-1	13 UPPER LINK BLOCK BOLT KIT		2	.80
	8145-2	14 LOWER LINK BLOCK BOLT KIT	2	2	.55
	ZF-GZN-02-1	15 GREASE FITTING		3	.06
	34910	16 HINGE PIN RETAINER		1	.19

1 YEAR SPARES, FOR 2 YEARS SPARES ADD 1 EA. OF \* THESE ITEMS