

## MG (100 TON) BOTTLENECK ELEVATOR

	RANGE	SIZE OF LINKS	WT.
30157	2 3/8" - 5"	1 3/4" - 2 3/4"	308-296

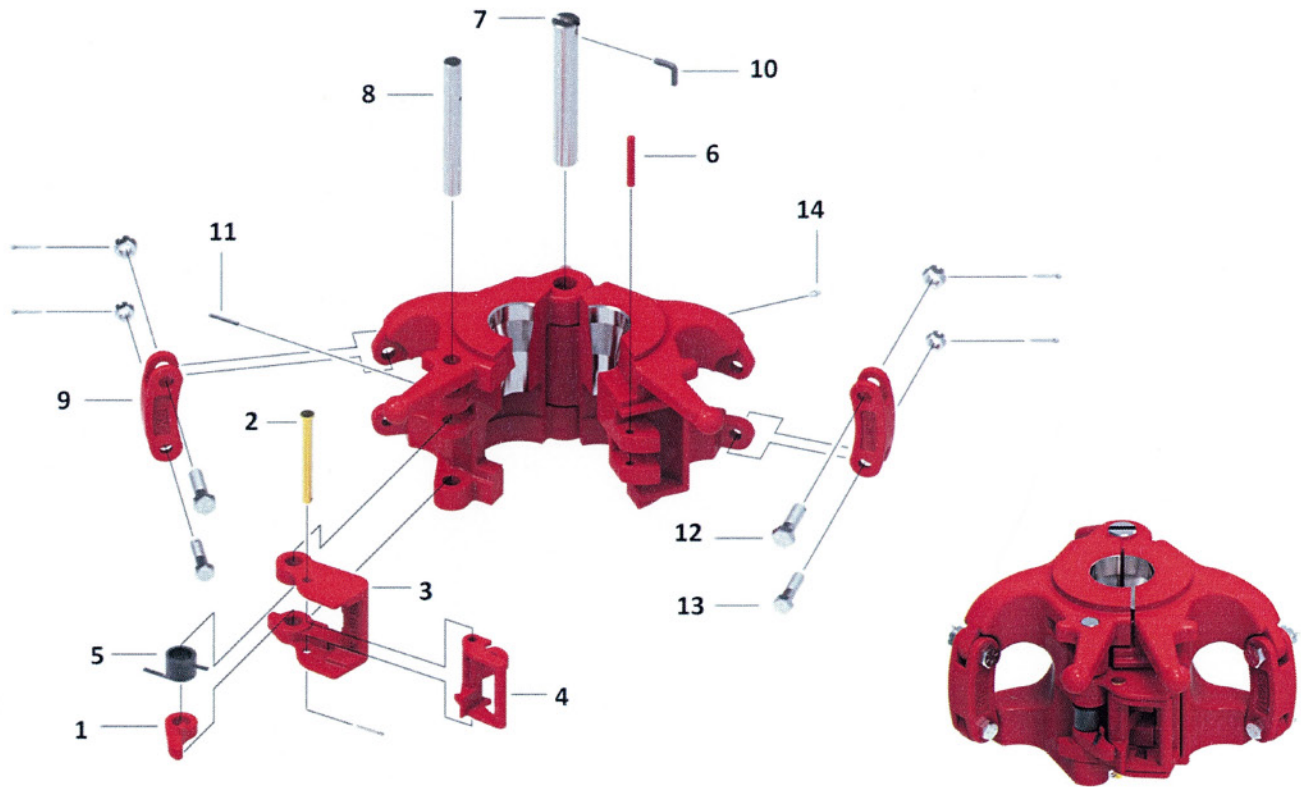

### REPLACEMENT PARTS FOR MG ELEVATORS

ITEM#	DESCRIPTION	**SPARES	#REQ.	WT.
11581	1 LATCH CAM	1	1	.75
11759	2 LATCH LOCK PIN	1	1	.75
11763	3 LATCH		1	9.25
11764	4 LATCH LOCK	*	1	3.00
11766	5 LATCH SPRING	2	1	.25
12529	6 DOOR LUG PIN		1	.25
26813	7 HINGE PIN	*	1	4.85
26814	8 LATCH PIN	*	1	.50
26817	9 LINK BLOCK		2	3.50
26813-RT	10 HINGE PIN RETAINER	1	1	.25
8156	11 LATCH PIN RETAINER	1	1	.25
8145-1	12 UPPER LINK BLOCK BOLT KIT	2	2	.80
8145-2	13 LOWER LINK BLOCK BOLT KIT	2	2	.55
ZF-GZN-02-1	14 GREASE FITTING		1	.10

\*\* 1 YEAR SPARES, FOR 2 YEARS SPARES ADD 1 EA. OF \* THESE ITEMS