

## GG (350 TON) BOTTLENECK ELEVATOR

	RANGE	SIZE OF LINKS	WT.
31068	3 1/2" - 5 1/2"	2 1/4" - 3 1/2"	715.00

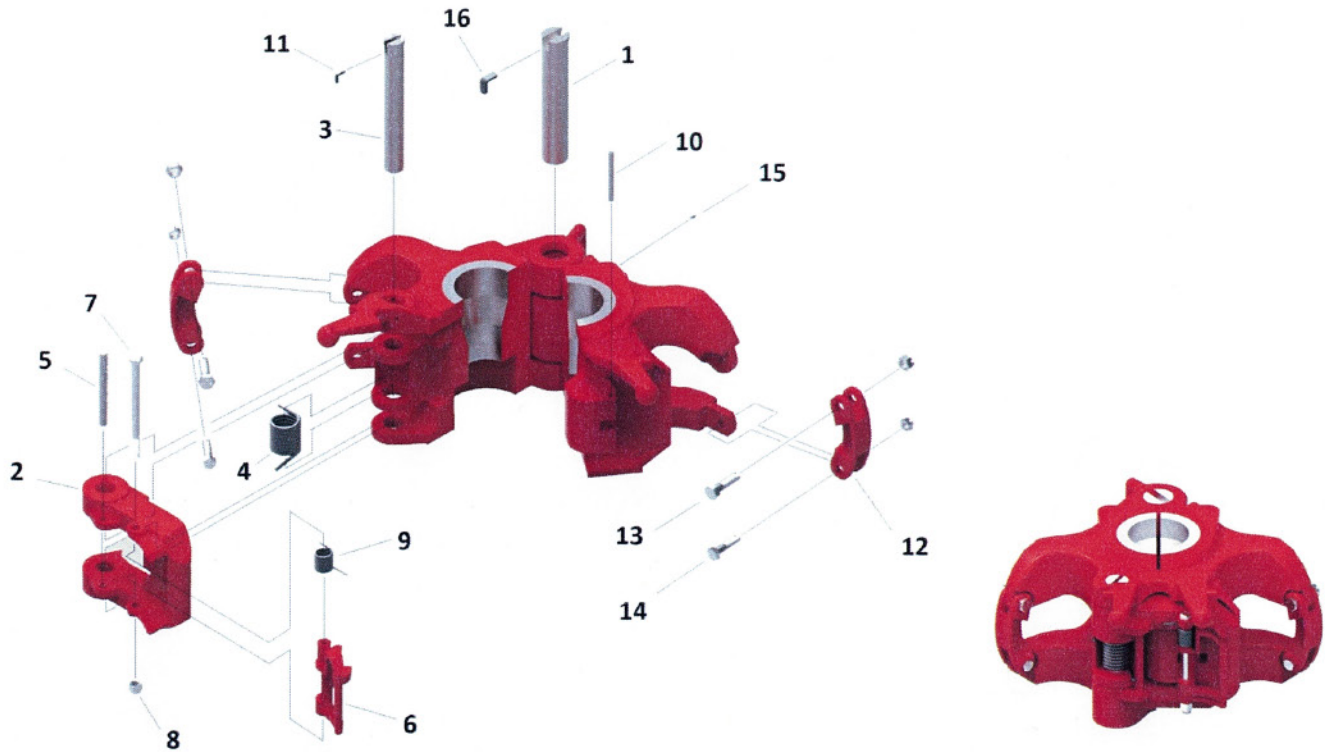

### REPLACEMENT PARTS FOR GG ELEVATORS

	ITEM#	DESCRIPTION	SPARES	#REQ.	WT.
33998	1	HINGE PIN	*	1	18.38
31071	2	LATCH		1	50.00
33999	3	LATCH PIN	*	1	10.38
18416	4	LATCH SPRING	2	1	2.25
13185	5	LATCH SPRING STOP	2	1	.94
13152	6	LATCH LOCK	*	1	4.00
15101	7	LATCH LOCK BOLT	2	1	1.30
939484-8	8	LATCH LOCK BOLT NUT	2	1	.20
13188	9	LATCH LOCK SPRING	2	1	.30
13190	10	DOOR LUG PIN		1	.32
32892	11	LATCH PIN RETAINER	2	1	.04
12732	N/P	DOOR CATCH ARM		1	1.50
12916	N/P	DOOR CATCH ARM PIN		1	.13
9561	N/P	DOOR CATCH SPRING	*	1	.13
12734	N/P	ROLLER		1	.50
12735	N/P	ROLLER PIN		1	.25
9519	12	LINK BLOCK		2	5.50
8145-1	13	UPPER LINK BLOCK BOLT KIT		2	.80
8145-2	14	LOWER LINK BLOCK BOLT KIT	2	2	.55
ZF-GZN-02-1	15	GREASE FITTING		1	.10
31074	16	HINGE PIN RETAINER	*	1	.50

1 YEAR SPARES, FOR 2 YEARS SPARES ADD 1 EA. OF \* THESE ITEMS