

AIR OPERATED SLIP LIFTING DEVICE (SLD)

DESCRIPTION

26-100-PD	"SLD AIR ACTUATOR – PIN DRIVE
26-100-SD	"SLD AIR ACTUATOR – SQUARE DRIVE

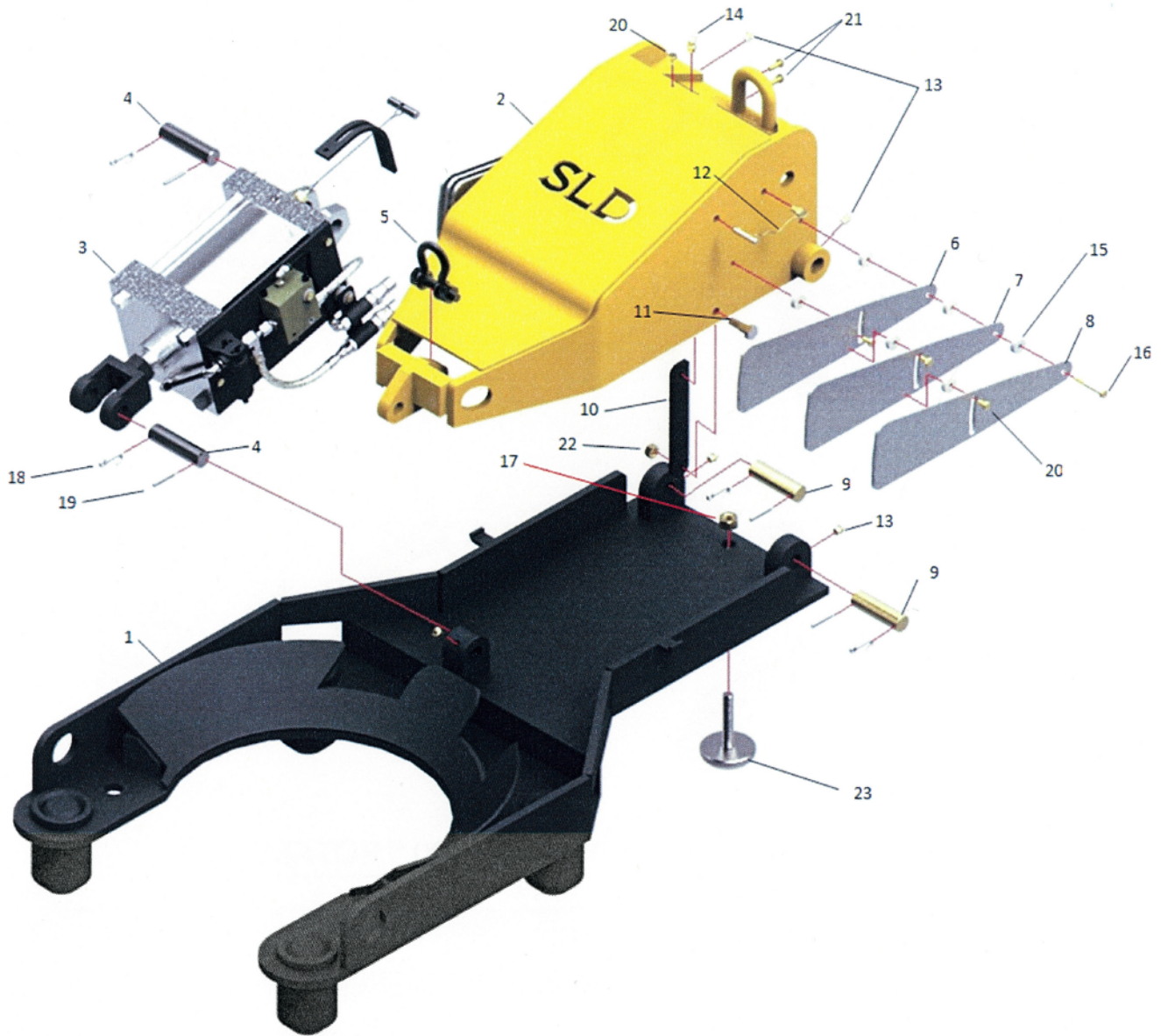

SPECIFICATIONS

PROPERTY	DESCRIPTION
MATERIAL	MILD STEEL
WEIGHT	260 LBS. (118KG) "SLD" ONLY W/O SLIP 525 LBS. (238 KG) WITH STORAGE STAND, CONTROL VALVE, AIR SUPPLY PLATE, AND HOSES
HEIGHT	RAISED 23.5" (597MM) - LOWERED (13.5" (343MM))
BASE DIMENSIONS	23.5" X 43.5" (600MM X 1105MM)
BASE OPENING	12.75" (327MM)
MINIMUM OPERATING PRESSURE	85 PSI

AIR OPERATED SLIP LIFTING DEVICE (SLD)

SLD PARTS LIST			
ITEM#	DESCRIPTION		QTY
26-145-PD	1	BASE PLATE FOR AIR OPERATED PIN DRIVE "SLD"	1
26-145-SD	1	BASE PLATE FOR AIR OPERATED SQUARE DRIVE "SLD"	1
26-165	2	LIFT ARM FOR AIR OPERATED "SLD"	1
26-115	3	CYLINDER ASSEMBLY FOR AIR OPERATED "SLD"	1
26-515-P	4	CYLINDER PIN FOR AIR OPERATED "SLD"	2
ZSHK-08-07	5	SHACKLE	1
26-165-S-I	6	INNER SIDE SHIELD FOR AIR OPERATED "SLD"	2
26-165-S-C	7	CENTER SIDE SHIELD FOR AIR OPERATED "SLD"	2
26-165-S-O	8	OUTER SIDE SHIELD FOR AIR OPERATED "SLD"	2
11-117	9	LIFT ARM PIN	2
26-165-K	10	KICKSTAND FOR AIR OPERATED "SLD"	1
26-167	11	KICKSTAND BOLT FOR AIR OPERATED "SLD"	1
26-165-M	12	KICKSTAND LOCK PIN WITH CABLE AND TIE DOWN BOLT	1
ZF-GZN-02-1	13	1/8" NPT GREASE ZERT, STRAIGHT	5
ZF-GZN-02-2	14	1/8" NPT GREASE ZERT, 45 DEG.	1
26-829-NW-1	15	NYLON WASHER	12
	16	1/4" X 2" GRADE 8 HEX HD CAP SCREW, ZINC	1
	17	5/8" GRADE 8 HEX NUT, ZINC	1
	18	3/16" X 1 1/2" COTTER PIN	4
	19	3/16" X 1 ROLL PIN	4
	20	1/4" X 1/2" GRADE 8 HEX HD CAP SCREW, ZINC	7
	21	1/4" X 3/8" GRADE 8 HEX HD CAP SCREW, ZINC	2
	22	5/8" GRADE 8 HEX NUT, ZINC	1
26-641-1	23	SUPPORT PAD ONLY FOR "SLD"	1

DU SLIP ADAPTOR KIT					
	4 1/2" DU (26-507-B)	5 1/2" DU (26-507-J)	5 1/2" SDU (26-507-D)	7" SDU & LD (26-507-E)	QTY REQ'D
LIFTING LINK	26-510-B	26-510-K	26-510-C	26-510-B	1
TORQUE BLOCK (L)	26-511-C	26-511-D-L	26-511-A-L	26-511-B	1
TORQUE BLOCK (R)	26-511-C	26-511-D-R	26-511-A-R	26-511-B	1
HINGE PIN	26-505	26-505-B	26-505-B	26-505-B	2
SPRING	26-518	26-518	26-518	26-518	2
HANDLE PINS	03-107	03-107	03-107	03-107	4

SD SLIP ADAPTOR KIT				
	ALL SDXL (26-507-A)	4 1/2" SDML (26-507-I)	5" SDML (26-507-H)	QTY REQ'D
LIFTING LINK	26-510-A	26-510-J	26-510-G	1
TORQUE BLOCK (L)	26-513-B	26-513-G	26-513-E	1
TORQUE BLOCK (R)	26-513-B	26-513-G	26-513-E	1
HINGE PIN	26-505-A	26-505-A	26-505-A	2
SPRING	26-518	26-518-REG	26-518-REG	2
HANDLE PINS	03-107	03-107	03-107	4