

40 TON MYT SLIP TYPE ELEVATOR

DESCRIPTION	LINK SIZE	WT.
29328 MYT ELEVATOR COMPLETE LESS SLIP ASSEMBLY.	1 1/4" - 2 3/4"	148.00

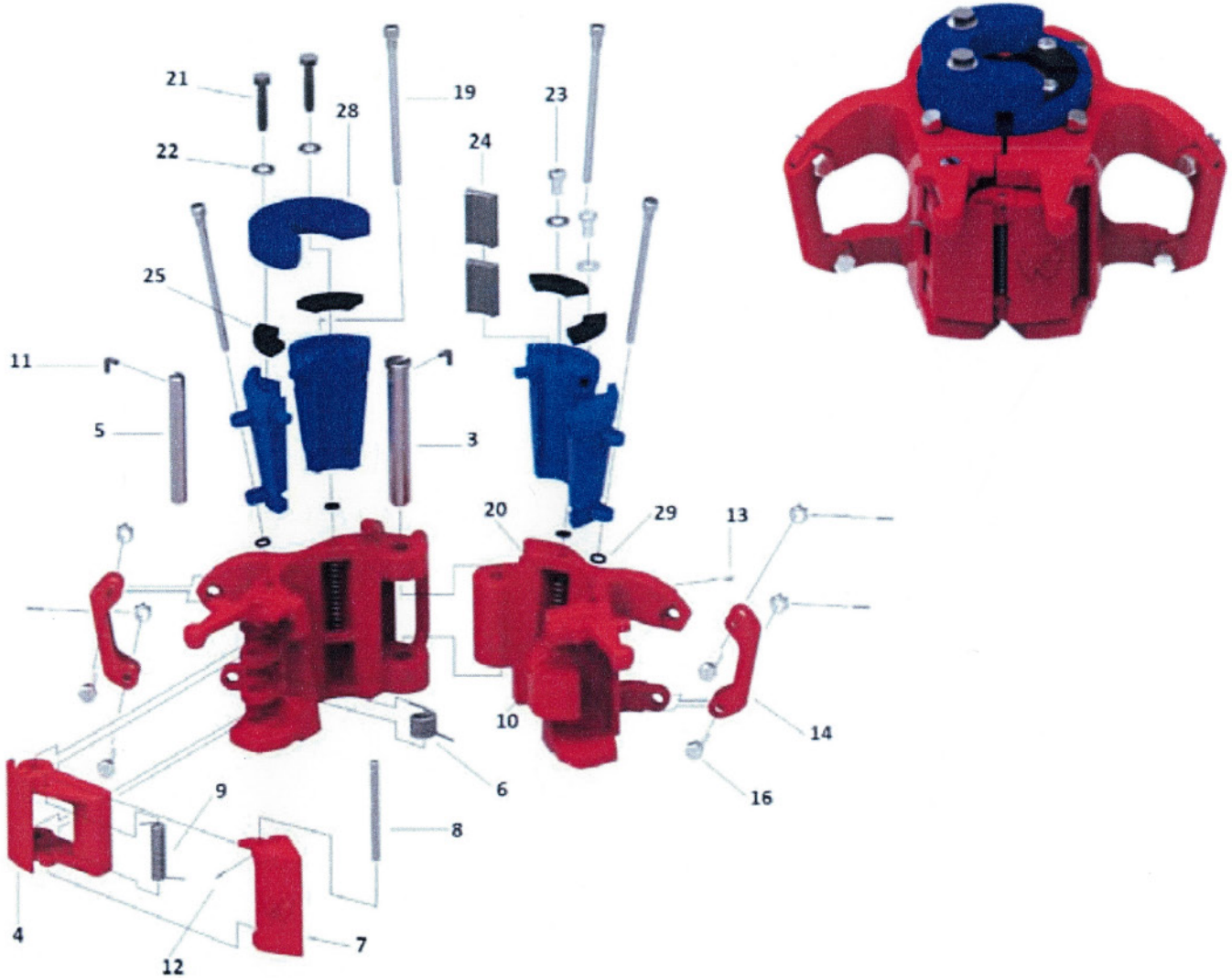

MYT SLIP ASSEMBLIES

DESCRIPTION	WT.
29343-1 2 7/8" X 2 7/8" MYT SLIP ASSEMBLY	44.00
29343-2 2 7/8" X 2 3/8" MYT SLIP ASSEMBLY	46.00
29343-3 2 7/8" X 2 1/16" MYT SLIP ASSEMBLY	47.25
29343-4 2 7/8" X 2" MYT SLIP ASSEMBLY	47.50
29343-5 2 7/8" X 1 1/2" (1.900") MYT SLIP ASSEMBLY	48.75
29343-6 2 7/8" X 1 1/4" (1.660") MYT SLIP ASSEMBLY	49.75
29343-7 2 7/8" X 1" (1.315") MYT SLIP ASSEMBLY	49.75
29343-8 2 7/8" X 3/4" (1.050") MYT SLIP ASSEMBLY	51.00
29343-10-S 2 7/8" MYT SLIP SEGMENTS ONLY (MATCHED SET OF 4)	31.00

40 TON MYT SLIP TYPE ELEVATOR

MYT REPLACEMENT PARTS

ITEM#	DESCRIPTION	**SPARES	# REQ.	WT.
29333	3 HINGE PIN		1	4.00
30652	4 LATCH		1	10.00
29334	5 LATCH PIN		1	4.00
29338	6 LATCH SPRING	2	1	.50
30653	7 LATCH LOCK		1	2.00
29335	8 LATCH LOCK PIN	2	1	.50
29349	9 LATCH LOCK SPRING	2	1	.25
30841	10 LATCH LOCK DOOR PIN		1	.50
947128-120	11 LATCH PIN RETAINER	2	1	1.50
947128-172	12 LATCH LOCK PIN RETAINER	2	1	.50
940308-1	13 GREASE FITTING		1	.10
30708	N/P LATCH & LATCH LOCK ASSY.		1	12.88
29337	14 LINK BLOCK		2	1.00
29359	15 USE P/N E939009-65		2	.13
939009-65	16 UPPER & LOWER LINK BLOCK PIN	2	2	.45
939484-7	17 LINK BLOCK NUT	2	2	.20
939672-18	18 COTTER PIN	2	2	.10
29336	19 SLIP BOLT	4	4	.75
29340	20 SLIP SPRING	8	4	.25
29347	21 SETTING RING SCREW	4	2	.25
939370-13	22 SETTING PLATE WASHER	4	2	.06
939098-15	23 INSERT RETAINER SCREW	4	2	.13
29344	25 INSERT RETAINER PLATE	4		.50

MYT INSERTS

ITEM#	DESCRIPTION	#REQ	WT.
24773	24 2 7/8" X 2 7/8" INSERT	8	.75
29255	24 2 7/8" X 2 3/8" INSERT	8	1.00
29256	24 2 7/8" X 2 1/16" & 2" INSERT	8	1.13
29257	24 2 7/8" X 1 1/2" (1.900") INSERT	8	1.25
29258	24 2 7/8" X 1 1/4" (1.660") INSERT	8	1.38
29259	24 2 7/8" X 1" (1.315") INSERT	8	1.44
29259-1	24 2 7/8" X 3/4" (1.050") INSERT	8	1.50

RECOMMENDED SPARES INCLUDE 2 SETTING RINGS FOR EACH PIPE SIZE TO BE RUN

MYT SETTING RINGS

ITEM#	DESCRIPTION	WT.
29348	28 2 7/8" MYT SETTING RING	6.50
29345	28 2 3/8" MYT SETTING RING	6.63
29350	28 2 1/16" MYT SETTING RING	7.00
29352	28 1 1/2" (1.900") SETTING RING	7.35
29353	28 1 1/4" (1.660") MYT SETTING RING	7.50
29354	28 1" (1.315") MYT SETTING RING	7.90
29354-1	28 3/4" (1.050") MYT SETTING RING	8.05

RECOMMENDED SPARES INCLUDE 2 SETTING RINGS FOR EACH PIPE SIZE TO BE RUN